

Overview, linear process



Landingpage



This screen lasts 3 seconds after opening the app and then go (without tap) to the next screen.

Homepage



**SLIDEBAR**  
Default: "Return" in orange.  
On slide left, "one way becomes orange. On slide right, Other cities becomes orange.

If new to site: autofill closest airport.  
If return visitor: autofill most recent search.  
  
On selection go to next screen, search outbound.

**DISCOVER** If selected take me to page with travel options and destinations.  
**MY TRIPS** If selected take me to page with already booked trips.  
**SUPPORT** If selected take me to Customer support, QnA etc.  
**LOG IN** If selected takes me directly to log in page.  
**SEARCH** If selected takes me to search page with advertisements of different destinations.

Search outbound

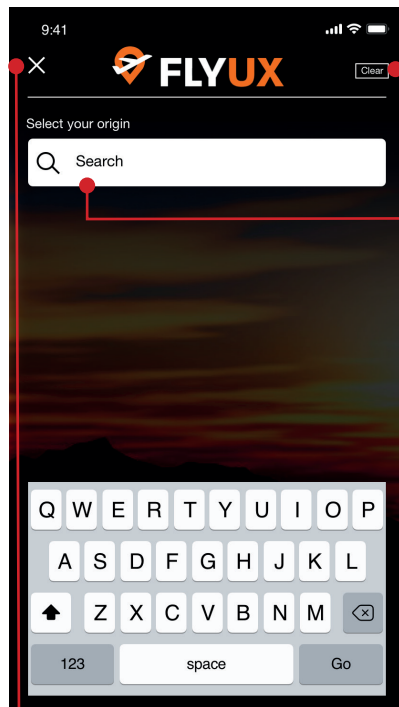

**FROM FIELD:**  
On selection blinking cursor. Validation occurs after cursor leaves field. Error message: Please enter valid airport.

When starting to type... three options of finding airport: If typed airport name, shortening or country... display dropdown list of alphabetical options of airports appear. i.e. Stockholm, ARN or Sweden.  
  
On selection in dropdown-list: Go back to homepage and autofill airport info.

On selection: Clear searchfield, back to blinking cursor.

Selected takes me back to Homepage.

Homepage



If new to site: autofill closest airport. If return visitor: autofill most recent search.

On selection go to next screen, search inbound.

Search inbound

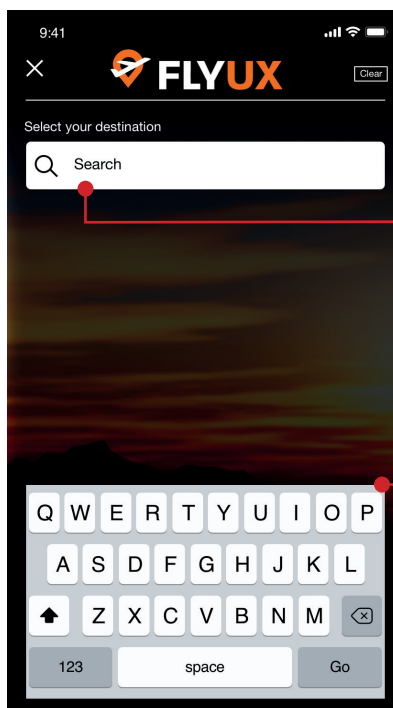

**TO FIELD:**  
Same as From field.

Only show destinations that are available from original airport.

On selection in dropdown-list: Go back to homepage and autofill airport info.

Letter keyboard

Homepage



Autofill: Display of todays date and three days ahead.

Selected opens calendar view.

Calendar1

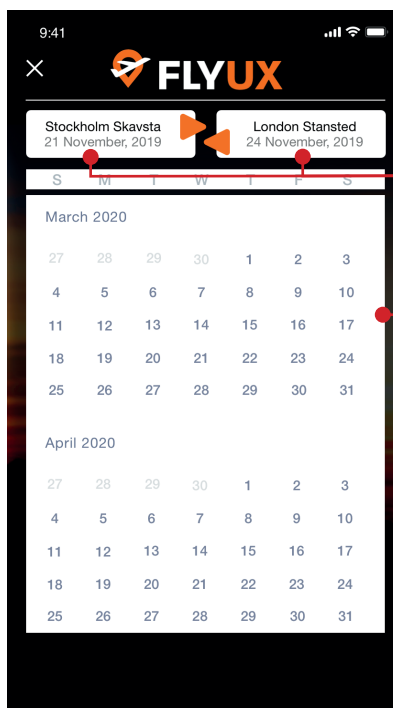

**VALIDATION**  
Autofill: Display previously selected airport info and todays date and three days ahead.

Autofill when i click dates in the calendar.

**CALENDAR**  
Scrollable up/down, months in order.  
Autostart with todays month.

Calendar2

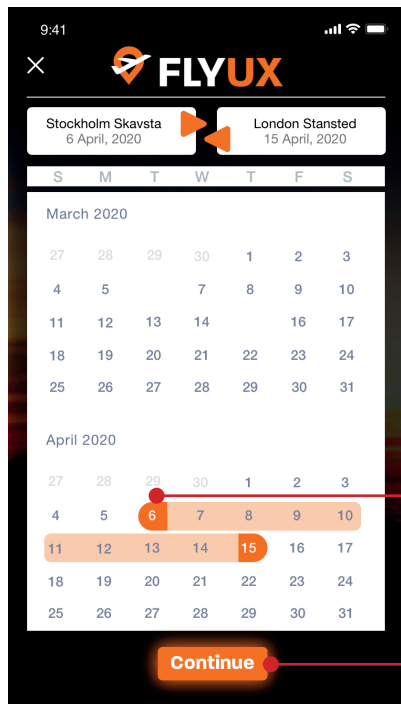

Selected first date becomes orange with white letters. Selected return date becomes orange and all dates in between light orange with grey letters.

Tap takes me back to Homepage.

Homepage



Tap takes me to lowcostcalendar.

Lowcostcalendar

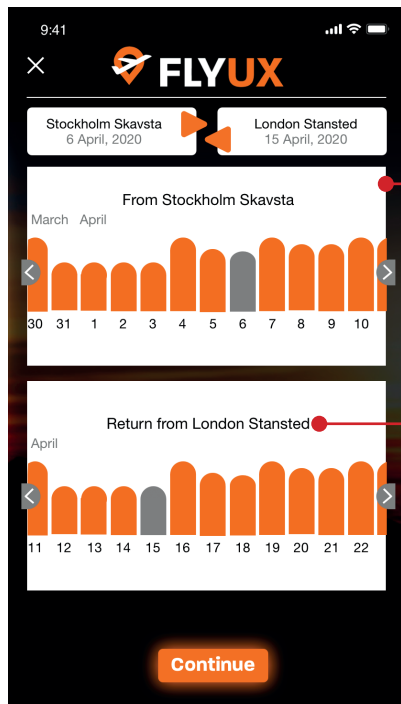

**LOWCOSTCALENDAR**  
Scrollable right/left with dates/months in order. Datecolumns symbolizes price. All datecolumns are orange except chosen ones that are grey. Tap a datecolumn and it changes to grey. The latest chosen one then becomes orange. From/Return heading is autofilled with selected airports.

Homepage



Tap takes me to passengers.



Passengers

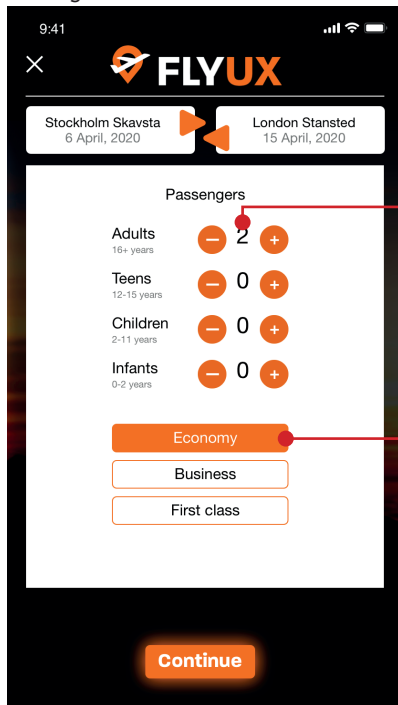

**PASSENGERS**  
Display 2 adults as default. If minus button is selected, display 1 (2-1). If plus button is selected, display 3 (2+1).

Autofill the other passenger options as 0 (none).

Autoselect Economy

Homepage



Tap takes me to next screen, waiting.

Waiting



Waiting for 3 sec, then automatically goes to next screen, select flight. Progress indicator rotates.

Back to last page.

Select flight

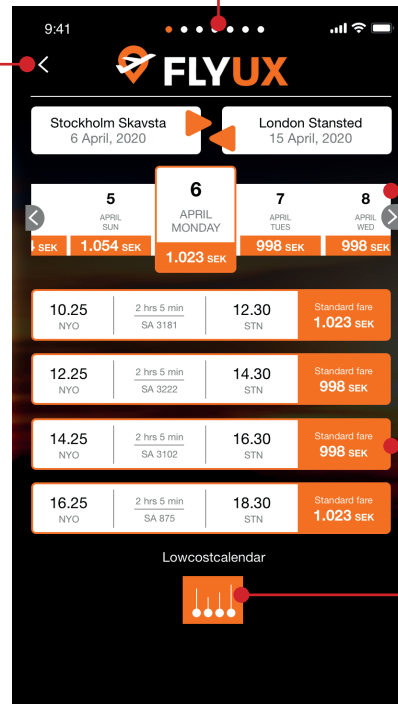

Step-by-step indicator in seven segments. White circles, and the selected page is orange.

**SELECT FLIGHT**  
Scrollable right/left with dates in order. Current date, displayed larger than the others. Tap date to select. Current date has times/flight options listed below.

Tap orange area to select flight. Autofill onto next page.

Back to lowcost-calendar.

Select flight return

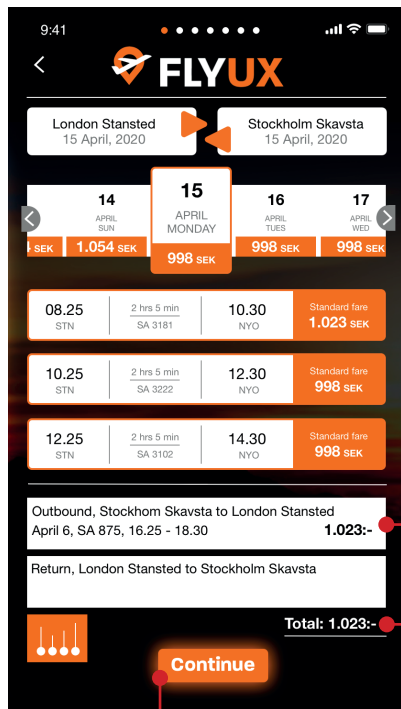

Autofill from selected flight from last page.

Total will change continuously while adding more to the cart.

Takes me to next page

Selected flight

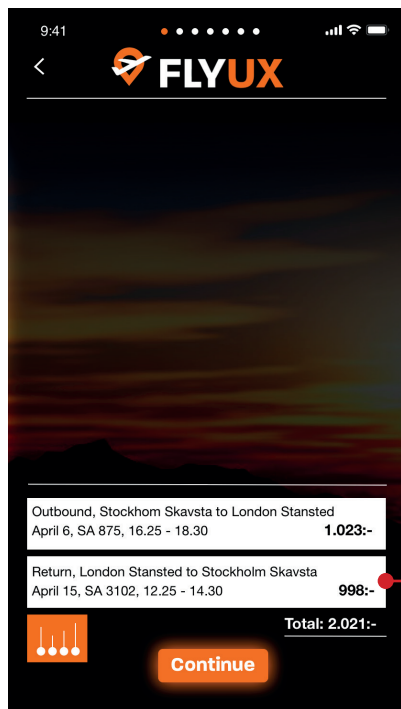

Autofill from selected flight from last page.

Seat outbound

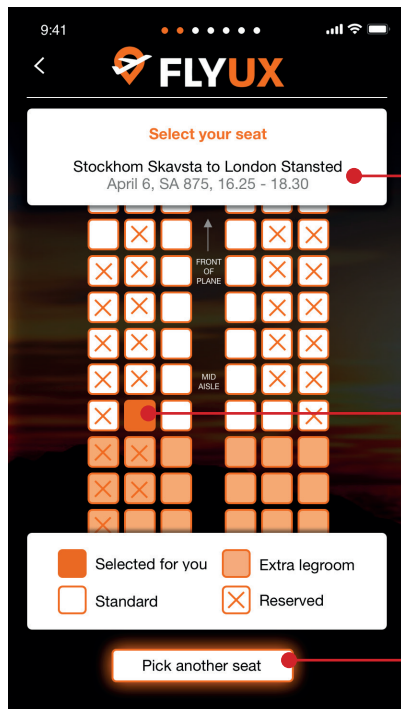

Autofill from selected flight.

SEATS  
Scroll drawing of plane up and down to view more seats.

Autofill orange. Random chosen seat for right amount of passengers.  
Click to select.

Click to pick another seat.

Seat outbound1

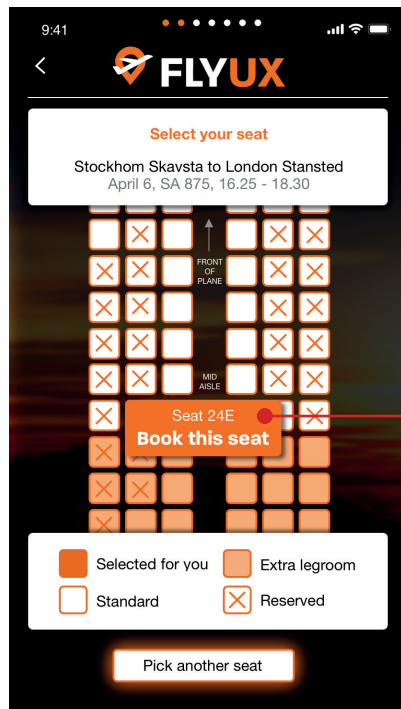

Validation of seat description appears on hovering.  
Tap to select.

Seat outbound2

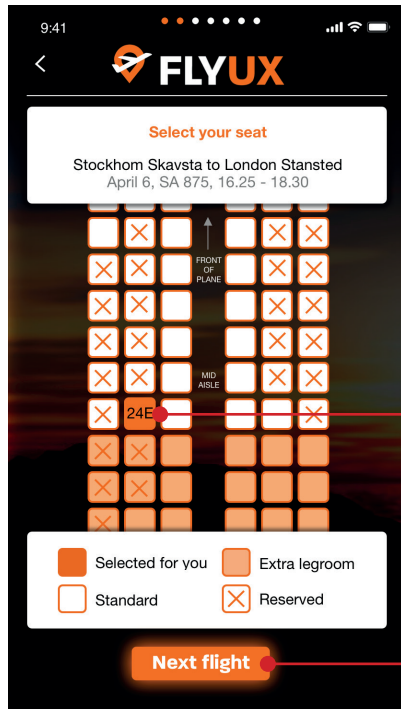

Validation of seat number in black.  
Tap to select.  
Same process for return flight.

Tap to select seats for return flight.

Baggage

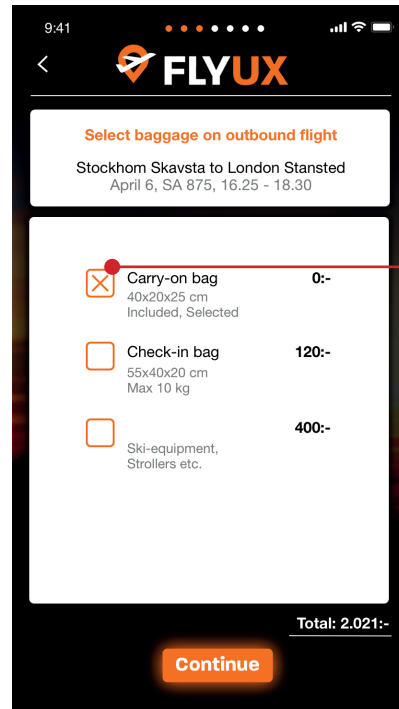

**BAGGAGE**  
Autoselected with an X. Select another box to unselect the autoselected box.

Meals

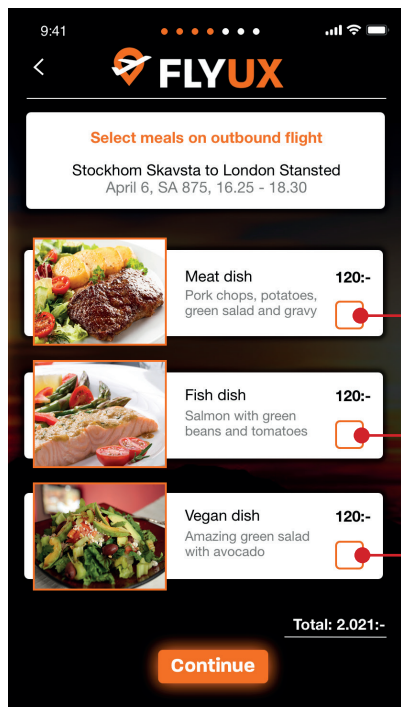

**MEALS**  
No autoselected meal.  
Selecting nothing is an option.  
Scroll down to see many different options.  
When selected a orange X will appear.  
Same for return flight.

Extras

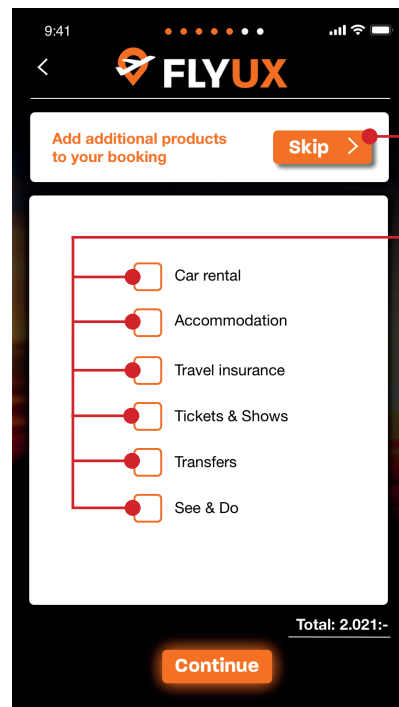

Tap here to skip and go to next screen.

No autoselected option.  
When selected a orange X will appear and you will go to a page with offers in that chosen category.

**REGISTER OR LOGIN**  
 On selection highlight field. Cursor in selected state. Only letters available in the field, no numbers or special characters. Mandatory field.  
 Validation occurs after cursor leaves field. Error message: Please remove numbers and special characters or you must complete this field to continue.  
 Display green "tick" if valid is entered.

Hint text: name@gmail.com removed when click field. Cursor in selected state.  
 Show dropdown of three recently used email addresses on click.  
 Validation occurs after cursor leaves field when input does not match standard email format. Error message: Please enter valid email address. You must complete this field to continue.

On selection, highlight field, display cursor ready for text input. Show password by default.  
 Validation when creating password: "The password has to be at least seven letters, 2 numbers".  
 Validation occurs after cursor leaves field. Error message: This password is incorrect, please try another password.  
 Display green "tick" if valid is entered.  
 Same info for the next field - Confirm password.

Register or Login

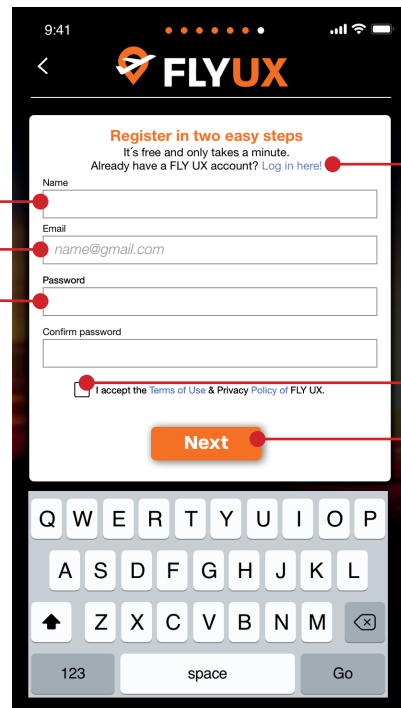

Tap here to skip to login page.

Tap here to say ok to terms. Can not go further without clicking the box.

Takes you to next page, create account.

Create new account

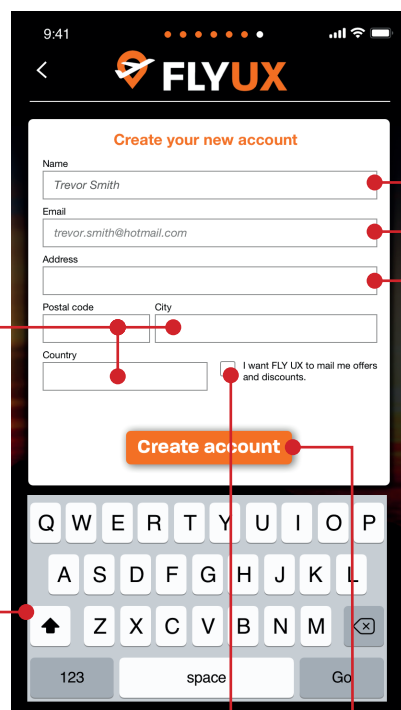

Autofill postal code, city, country from selected street address, or type it manually. Change keypad to numeric for postal code field. Display green "tick" if valid is entered.

Default letter keypad.

Autofill name removed if click field. Cursor in selected state. Only letters available in the field, no numbers or special characters. Mandatory field. Validation occurs after cursor leaves field. Error message: Please remove numbers and special characters or you must complete this field to continue. Display green "tick" if valid is entered.

Autofill email removed if click field. Cursor in selected state. Show dropdown of three recently used email addresses on click. Change to keypad for email addresses. Validation occurs after cursor leaves field when input does not match standard email format. Error message: Please enter valid email address. You must complete this field to continue. Display green "tick" if valid is entered.

On selection highlight field. Cursor in selected state. Autosuggest street addresses recently used in dropdown menu. If your address is not in the dropdown menu, you can type it manually. Error message: Please enter your address. Validation occurs after cursor has left field, when input is empty. Display green "tick" if valid is entered. Mandatory field. Error message: You must provide an address to continue.

Option to click box or leave blank. Clicked box: X appear. Email-address gets stored in FLU UX database.

Takes you to payment.

Log in

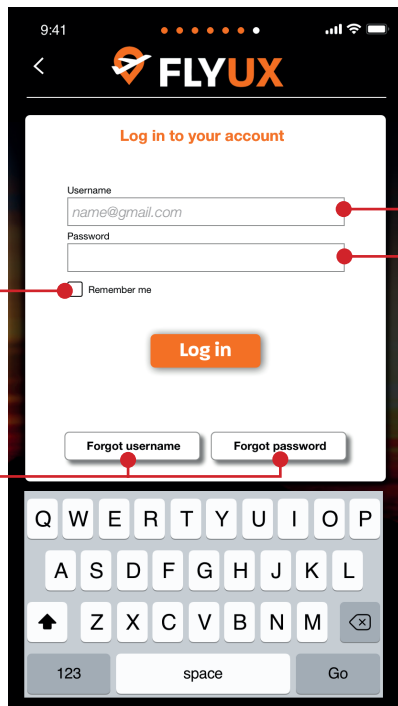

Option to click box or leave blank. Clicked box: X appear. Information about logged in user is stored in database.

If clicked, an email is sent to the user with option to enter new username or option to reset password.

Hint text email removed if click field. Cursor in selected state. Username: Optional emailaddress or other username. Change to keypad for emailaddresses. Validation occurs after cursor leaves field. Error message if left blank: Please enter a username. You must complete this field to continue. Display green "tick" if valid is entered.

On selection, highlight field, display cursor ready for text input. Display letters when typing, not dots. Validation occurs after cursor leaves field. Error message if left blank: Please enter password. Error message if invalid password is entered: Please enter valid password with minimum seven letters and two numbers. Display green "tick" if valid is entered.

Passenger info

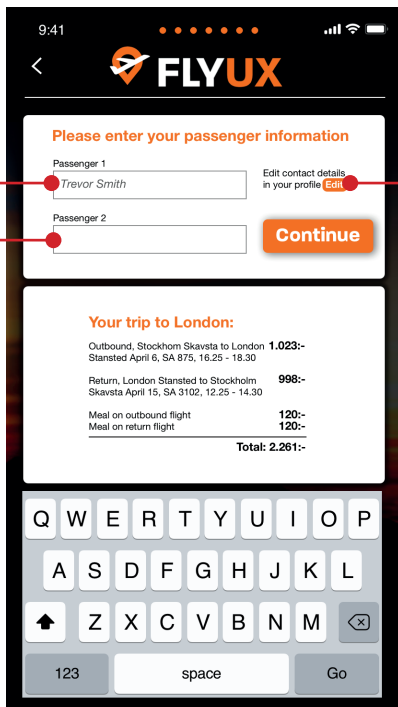

**PASSENGER**  
Autofill name removed if click field. Cursor in selected state. Only letters available in the field, no numbers or special characters. Mandatory field. Validation occurs after cursor leaves field. Error message: Please remove numbers and special characters or you must complete this field to continue. Display green "tick" if valid is entered.

Cursor in selected state. Only letters available in the field, no numbers or special characters. Validation occurs after cursor leaves field. Error message: Please remove numbers and special characters or you must complete this field to continue. Display green "tick" if valid is entered.

Click here to edit contact information of logged in user. Takes you to a page with current contact details.



**Payment**

**Payment**  
Upon selection, highlight the chosen payment method.  
Credit card option as default.

Upon selection, highlight field. Only allow numbers - no letters or special characters. Numbers are auto-formatted into four groups of four numbers in each with a space between. Validation occurs after cursor leaves field. Error message: I'm sorry, the card you have entered appears not to be valid. Please try again.

Display green "tick" if valid is entered.

Upon selection, highlight field. Only allow numbers - no letters or special characters. Numbers are auto-formatted into two groups of two with a "/" in between: MM/YY. Validation occurs after cursor leaves field. Error message: Please enter a valid expiry date on the back of your card.

Display green "tick" if valid is entered.

Upon selection, highlight field. Only allow numbers - no letters or special characters. Maximum of 3 numbers. Validation occurs after cursor leaves field. Error message: Please enter the three digit number on the back of your card. Please try again.

Display green "tick" if valid is entered.

Gives me option to photograph my card instead of typing the info.

Cursor in selected state. Only letters available in the field, no numbers or special characters. Mandatory field. Validation occurs after cursor leaves field. Error message: Please remove numbers and special characters.

Display green "tick" if valid is entered.

**End frame**

Option to select. If selected takes you to page with descriptions and options. Tap anywhere else on the page, and you go back to the start.

E-Tickets

Tickets on pdf

Print tickets

Get tickets on SMS

Get tickets via snailmail

Thank you!  
Have a good trip!